

Hunters Ridge

Village of Waldo

| | |
|----|-------------|
| 18 | \$9,900.00 |
| 19 | \$9,900.00 |
| 20 | \$9,900.00 |
| 21 | \$9,900.00 |
| 22 | \$14,900.00 |
| 23 | \$19,900.00 |

**HOME/LOT PACKAGES
AVAILABLE**

Village Water/Sewer Lateral to Lot

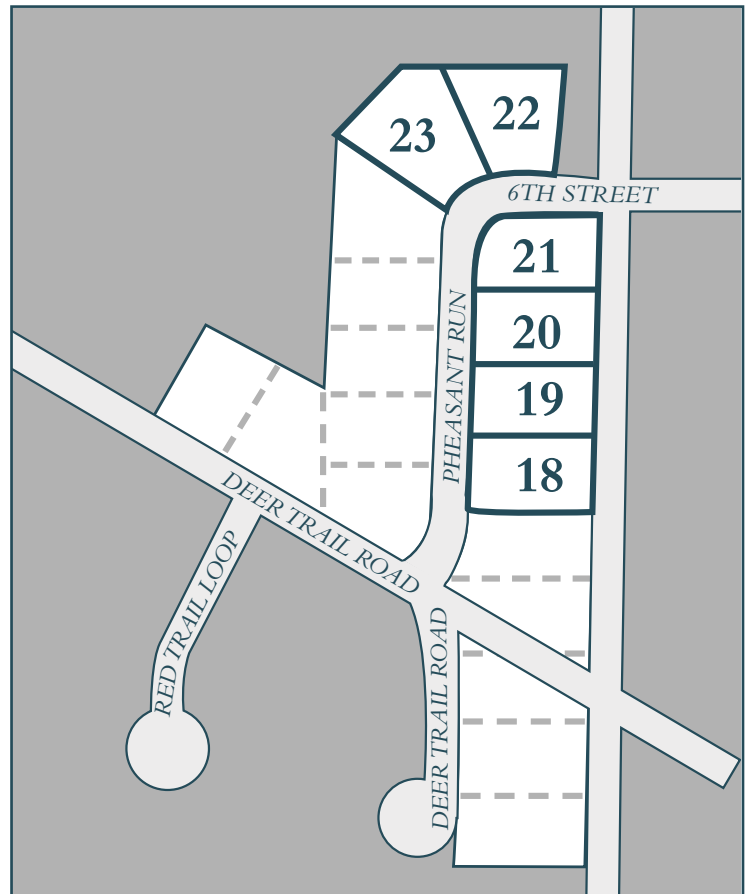

POSTHUMA
— H O M E S —

920-226-4062 • posthumahomes.com



Find us on 

